

EAST SUSSEX COUNTY COUNCIL
ROAD TRAFFIC REGULATION ACT 1984

**The East Sussex (Public Footpaths Newhaven 3c (part) and Newhaven 3e)
(Temporary Footpaths Closure) Order 2019**

To protect public safety during work to construct a new road (the Newhaven Port Access Road (NPAR)), East Sussex County Council have made an Order under Sections 14(1) and 15(1)(a) of the Road Traffic Regulation Act 1984, as amended, which will temporarily close the following footpaths

Temporary Footpaths Closure

Part of **Public Footpath Newhaven 3c** will be closed to all users between TQ 4549 0088 and TQ 4549 0095 for a distance of 80 metres. An alternative route will be available via footpaths Newhaven 3c, Newhaven 3b, part of Newhaven 4a, then in a southerly direction along the proposed route of the NPAR to Newhaven 3d and vice versa.

The whole of **Public Footpath Newhaven 3e** will be closed to all users between TQ 4562 0093 and TQ 4555 0089 for a distance of 80 metres. An alternative route will be available via footpaths Newhaven 3d, then in a northerly direction along the proposed route of the NPAR to part of Newhaven 4a, then Newhaven 3b and vice versa.

The closure will be in force for 6 months from 15 February 2019, or until the works are completed, whichever is the earlier, which after this period will require an extension from the Secretary of State, should the footpaths still be unfit to use.

If you require any further information you should telephone the Rights of Way Office on 0345 60 80 193.

Philip Baker, Assistant Chief Executive, East Sussex County Council, County Hall, Lewes, East Sussex BN7 1UE

8 February 2019

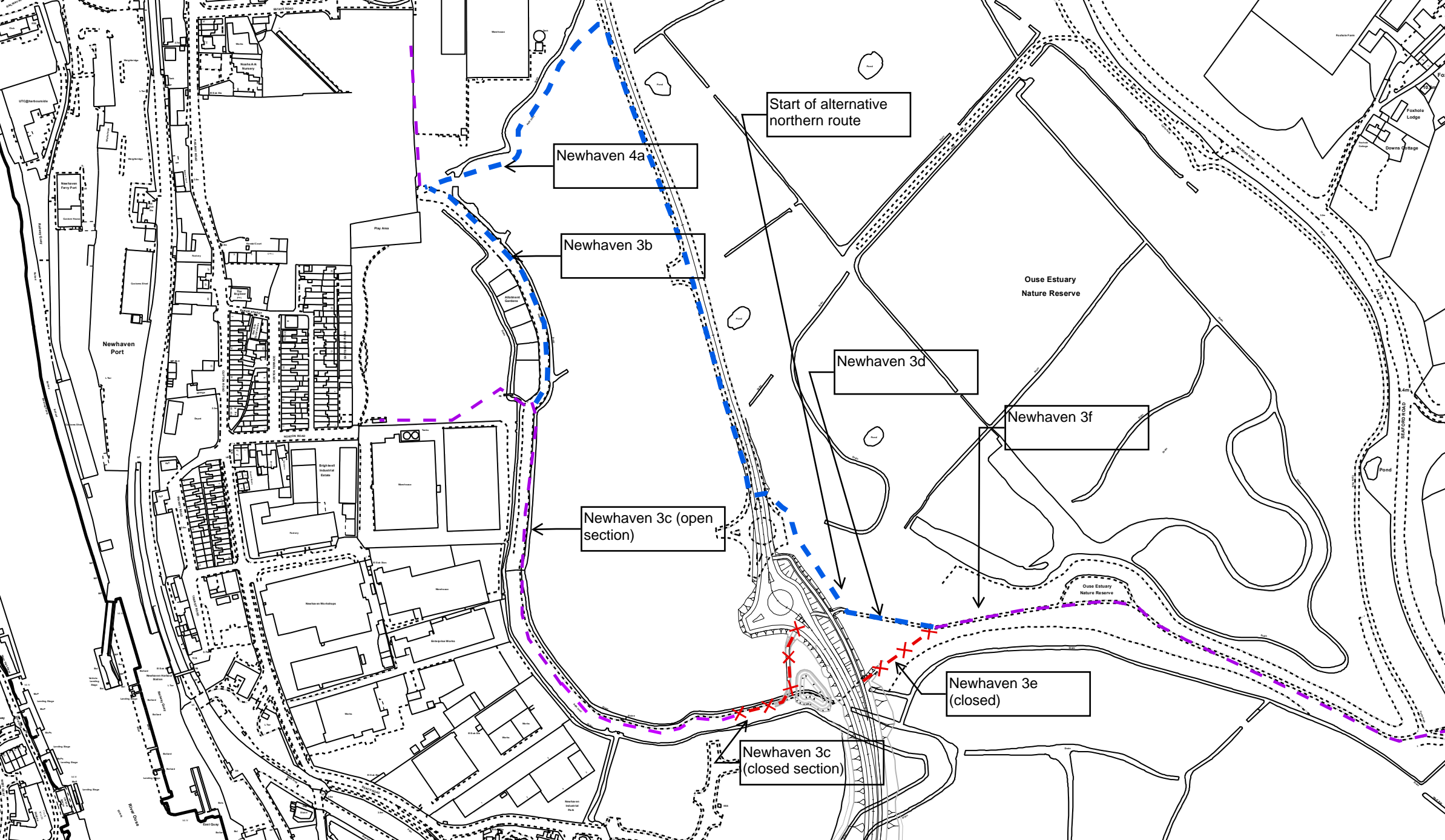

Start of alternative northern route

Newhaven 4a

Newhaven 3b

Newhaven 3d

Newhaven 3f

Newhaven 3c (open section)

Newhaven 3e (closed)

Newhaven 3c (closed section)

Newhaven Port

Play Area

Highland Industrial Estate

Ouse Estuary Nature Reserve

Ouse Estuary Nature Reserve

Foothole Lodge

Downs Cottage

Pond