

**PART A: Information relating to the applicant and land to which the application relates:**

*(All applicants must complete this Part)*

1. Name of appropriate authority to which the application is addressed:

**East Sussex County Council**

2. Name and full address (including postcode) of applicant:

**East Sussex County Council**

**County Hall, St Annes Cres**

**Lewes, BN7 1UE**

3. Status of applicant (tick relevant box or boxes):

I am

a)  the owner of the land(s) described in paragraph 4.

b)  making this application and the statements/declarations it contains on behalf of

**East Sussex County Council** who is the owner of the land(s) described in paragraph 4 and in my capacity as [Assistant Surveyor, Acquisitions & Disposals, ESCC](#).

4. Insert description of the land(s) to which the application relates (including full address and postcode):

Former St Anne's School Site,

Rotten Row, Lewes,

BN7 1LJ

5. Ordnance Survey six-figure grid reference(s) of a point within the area of land(s) to which the application relates (if known):

TQ 40862 09863

6. This deposit comprises the following statement(s) and/or declarations

*(delete Parts B, C, or D where not applicable):*

**PART B: Statement under section 31(6) of the Highways Act 1980**

**East Sussex County Council** is the owner of the land described in paragraph 4 of Part A of this form and shown *outlined in red* on the map accompanying this statement.

*(Delete wording in square brackets as appropriate and/or insert information as required)*

No [other] ways over the land shown *outlined in red* on the accompanying map have been dedicated as highways.

*(Delete wording in square brackets as appropriate and/or insert information as required)*

**PART D: Statement under section 15A(1) of the Commons Act 2006**

**East Sussex County Council** is the owner of the land described in paragraph 4 of Part A of this form and shown *outlined in red* on the map accompanying this statement/deposited with **East Sussex County Council** on **13.06.18**.

**East Sussex County Council** wishes to bring to an end any period during which persons may have indulged as of right in lawful sports and pastimes on the whole or any part of the land shown *outlined in red* on the **accompanying map**.

**PART E: Insert any additional information relevant to the application**

**PART F: Statement of Truth**

*(All applicants must complete this Part)*

WARNING: If you dishonestly enter information or make a statement that you know is, or might be, untrue or misleading, and intend by doing so to make a gain for yourself or another person, or to cause loss or the risk of loss to another person, you may commit the offence of fraud under section 1 of the Fraud Act 2006, the maximum penalty for which is 10 years' imprisonment or an unlimited fine, or both.

**I BELIEVE THAT THE FACTS AND MATTERS CONTAINED IN THIS FORM ARE TRUE**

Signature (of the person making the statement of truth):

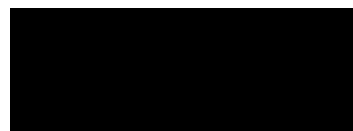

Print full name: Kate Victoria Nicholson

Date: 21/12/17

***You should keep a copy of the completed form***

## **Data Protection Act 1998 - Fair Processing Notice**

The purpose of this Fair Processing Notice is to inform you of the use that will be made of your personal data, as required by the Data Protection Act 1998.

The appropriate authority (see explanation of definition in above guidance notes) in England is the data controller in respect of any personal data that you provide when you complete this form.

The information that you provide will be used by the appropriate authority in its duties to process applications to deposit statements, maps and declarations under section 31(6) the Highways Act 1980 and statements under section 1 5A(1) of the Commons Act 2006. The information you provide will also be used by the appropriate authority in its duty to update the registers in which details of such deposits are recorded under the Dedicated Highways (Registers under Section 3 1A of the Highways Act 1980) (England) Regulations 2007 and the Commons (Registration of Town or Village Greens) and Dedicated Highways (Landowner Statements and Declarations) (England) Regulations 2013.

The appropriate authority is required by the legislation above to maintain a register which holds information provided in this form, which can be inspected online or in person by members of the public on request. It may also be required to release information, including personal data and commercial information, on request under the Environmental Information Regulations 2004 or the Freedom of Information Act 2000. However, the appropriate authority will not permit any unwarranted breach of confidentiality nor will they act in contravention of their obligations under the Data Protection Act 1998.

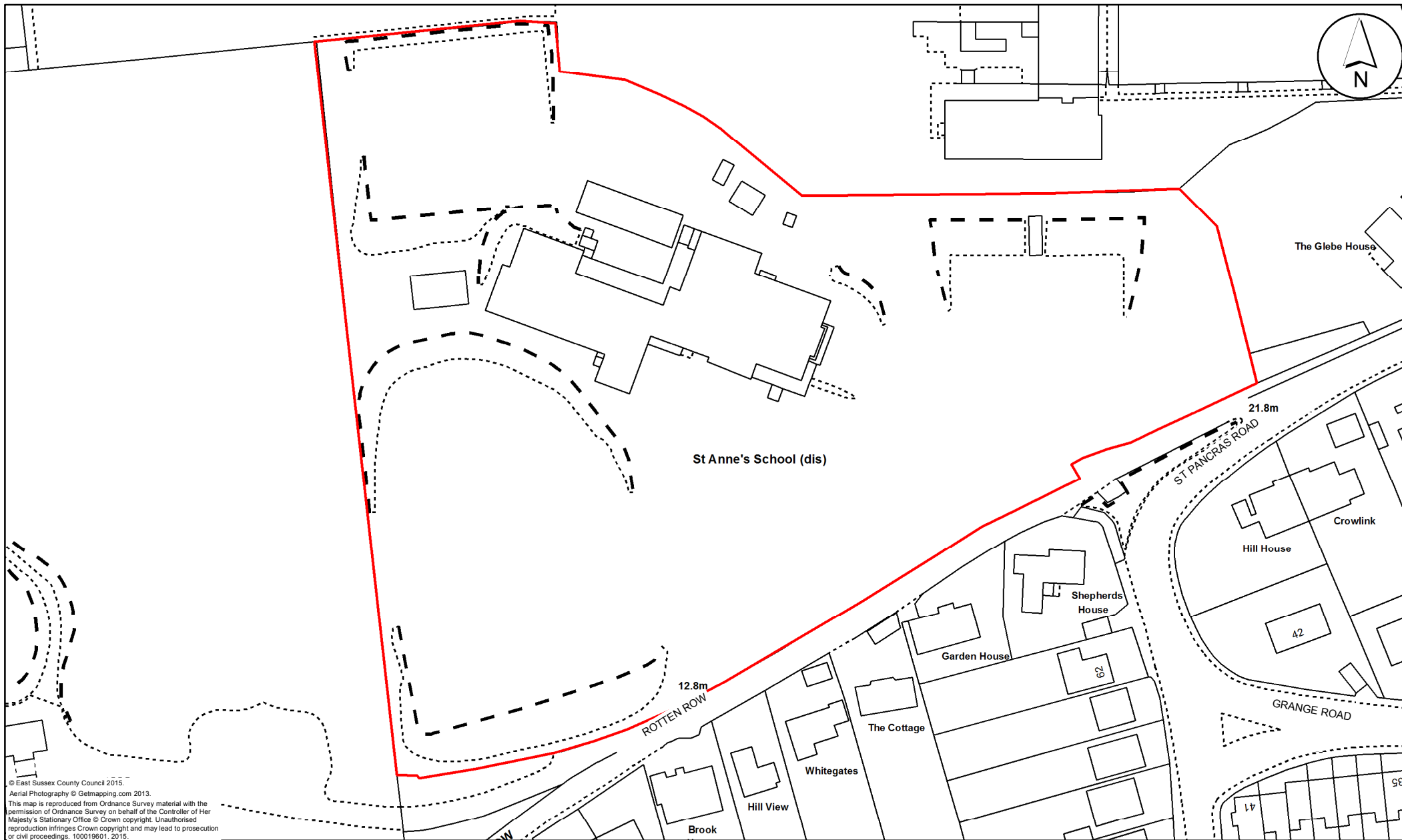

© East Sussex County Council 2015.  
 Aerial Photography © Getmapping.com 2013.  
 This map is reproduced from Ordnance Survey material with the permission of Ordnance Survey on behalf of the Controller of Her Majesty's Stationary Office © Crown copyright. Unauthorised reproduction infringes Crown copyright and may lead to prosecution or civil proceedings. 100019601. 2015.

<b>Map Title:</b> St Annes, Rotten Row, Lewes - Deposition Plan	
<b>Date:</b> 21.12.17	<b>Map No:</b> 012
<b>Scale:</b> 1:1,000	<b>Author:</b> KVN





**Frequently asked questions about this notice and map:**

**What is this notice and map?** This is a deposit made under Section 31(6) of the Highways Act 1980 and Section 15A of the Commons Act 2006 ("the 2006 Act")

This deposit is a statement by the landowner to publically record the access rights that they recognise over their land. The deposit is made to prevent additional public rights from being recorded over the land in question.

**Why is the notice and map displayed in the countryside?**

When a landowner submits a deposit, East Sussex County Council has to display the notice and map on the affected area of land.

**What does the deposit apply to?** Deposits apply to public rights of way (footpaths, bridleways and byways), commons and town & village greens.

More information is available here: [www.eastsussex.gov.uk/rightsofway](http://www.eastsussex.gov.uk/rightsofway)

Form of Notice of Application

**East Sussex County Council:** An application to deposit a map and statement under section 31(6) of the Highways Act 1980 has been made in relation to the land described below and shown in red on the accompanying map.

**Please note:** This deposit may affect rights over the land described below. Deposits made under section 31(6) of the Highways Act 1980 may prevent deemed dedication of public rights of way over such land under section 31(1) of that Act. Deposits made under section 15A(1) of the Commons Act 2006 may affect the ability to register such land as a town or village green under section 15 of that Act. Please see guidance at <http://www.defra.gov.uk/rural/protected/greens/> for further information.

Description of the land(s) (including full address and postcode):

**Former St Anne's School Site, Rotten Row, Lewes, BN7 1LJ**

Name of the Parish, Ward or District in which the land(s) is situated:

**Lewes**

The deposit was submitted by **Kate Nicholson** on behalf of **East Sussex County Council** and was received by this authority on **13<sup>th</sup> June 2018**.

The authority maintains a register of maps, statements and declarations deposited under section 31A of the Highways Act 1980 and section 15B of the Commons Act 2006

This register can be accessed online at [www.eastsussex.gov.uk/rightsofway](http://www.eastsussex.gov.uk/rightsofway) or the original document can be inspected free of charge at:

**The Keep, Woollards Way, Brighton, BN1 9BP.**

Opening Hours: Tuesday - Friday 9.30am to 5.00pm. Saturday 9.30am to 4.00pm.

Signed on behalf of East Sussex County Council:

Louise Bottomley

Definitive Map Assistant, East Sussex County Council. Tel:0345 6080193

Date: **18<sup>th</sup> June 2018**